

# GENERAL NOTES

- ALL WORK SHALL COMPLY WITH THE REQUIREMENTS OF THESE DRAWINGS, THE SPECIFICATIONS, AND THE CURRENT EDITIONS OF THE IBC, UMC, UPC, NEC AND THE NW NON-RESIDENTIAL ENERGY CODE, AND ALL CITY OF PASCO REGULATIONS. CONTRACTOR SHALL BE RESPONSIBLE FOR OBTAINING ALL REQUIRED PERMITS (EXCEPT FOR BUILDING PERMIT WHICH IS PAID FOR BY OWNER) AND PROVIDING ALL REQUIRED DOCUMENTATION FOR ISSUANCE OF PERMITS, INCLUDING ANY AND ALL ENGINEERING, STAMPED AND SIGNED BY REGISTERED PROFESSIONAL ENGINEERS IN THE STATE OF WASHINGTON APPROPRIATE TO THE DISCIPLINE.
- THE CONTRACTOR AGREES TO ASSUME SAFE AND COMPLETE RESPONSIBILITY FOR THE JOB SITE DURING THE COURSE OF THE PROJECT, INCLUDING THE SAFETY OF ALL PERSONS AND PROPERTY, THAT THIS REQUIREMENT SHALL APPLY CONTINUOUSLY AND NOT BE LIMITED TO NORMAL WORKING HOURS, AND THAT THE CONTRACTOR SHALL DEFEND, INDEMNIFY AND HOLD THE ARCHITECT AND OWNER HARMLESS FROM ANY AND ALL LIABILITY, REAL OR ALLEGED, IN CONNECTION WITH THE PERFORMANCE OF WORK ON THIS PROJECT, EXCEPTING FOR LIABILITY ARISING FROM THE SOLE NEGLIGENCE OF THE OWNER OR ARCHITECT, OR THIRD PARTY IN VIOLATION OF THE LAW OR IN TRESPASS. THE CONTRACTOR SHALL PRACTICE SAFETY AT ALL TIMES AND SHALL FURNISH, ERECT, AND MAINTAIN SUCH FENCES, BARRICADES, LIGHTS, AND SIGNS NECESSARY TO GIVE ADEQUATE PROTECTION TO THE PUBLIC AT ALL TIMES. THE ARCHITECT MAKES NO WARRANTY THAT THE CONSTRUCTION-PHASE FENCES, ETC., ARE ADEQUATE TO ENSURE SAFETY DURING CONSTRUCTION OPERATIONS.
- PLAN INTENT: THESE DRAWINGS REPRESENT EXISTING CONDITIONS (CONTRACTOR TO VERIFY ALL ACTUAL CONDITIONS), AND THE FINISHED FACILITIES AND UNLESS OTHERWISE INDICATED, THEY DO NOT SHOW THE METHOD OF CONSTRUCTION. THE CONTRACTOR SHALL PROVIDE ALL MEASURES NECESSARY TO PRODUCE THE FINISHED FACILITIES AND TO PROTECT THE WORK AND PROPERTY, THE SAFETY OF THE WORKERS, AND OTHER PERSONS DURING CONSTRUCTION. THE CONTRACTOR IS SOLELY RESPONSIBLE FOR THE ABOVE MEASURES AND VISITS TO THE SITE BY THE ARCHITECT SHALL NOT INCLUDE OBSERVATION OF SAFETY MEASURES.
- DURING CONSTRUCTION THE SAFETY OF THE WORKERS, VISITORS, AND THE PROTECTION OF PROPERTY IS SOLELY THE RESPONSIBILITY OF THE CONTRACTOR. THE ARCHITECT SHALL NOT INCLUDE OBSERVATION OF SAFETY MEASURE IN SITE VISIT OBSERVATIONS REPORTS.

# PORT OF PASCO T-179 BUILDING RE-ROOF

2440 E AINSWORTH AVE  
PASCO, WASHINGTON 99301

## ABBREVIATIONS

ACOUST.	ACOUSTICAL	MDPD	MEDIUM-DENSITY
ADJ.	ADJACENT	MEMB.	PARTICLE BOARD
ADJA.	ADJUSTABLE	MIN	MEMBRANE
AFF	ABOVE FINISHED FLOOR	NONPERF.	MINIMUM
ALT.	ALTERNATE	N.T.S	NONPERFORATED
ALUM.	ALUMINUM	NO.	NOT TO SCALE
ASSEM.	ASSEMBLY	O.C.	NUMBER
BF	BRACE FRAME	OF CI	ON CENTER
BLKG.	BLOCKING	OFOI	OWNER FURNISHED
BLDG.	BUILDING	OPNG.	CONTRACTOR INSTALLED
BD.	BOARD	OPP.	OWNER FURNISHED
B.O.	BOTTOM OF	O.H.	OWNER INSTALLED
CL.G.	CEILING	O.S.	OPENING
CL.	CENTER LINE	PERF.	OPOSITE
C	CHANNEL	PERIM.	OVERHEAD
C.O.	CLEAN OUT	PLYWD.	OVERFLOW SCUPPER
CLR.	CLEAR	PLAST.	PERFORATED
COMP.	COMPOSITION	POS.	PERIMETER
CONC.	CONCRETE	PREFAB.	PLYWOOD
CMU	CONCRETE MASONRY UNIT	PREMANUF.	PLASTIC
CONSTR.	CONSTRUCTION	PT	POSITIVE
CONT.	CONTINUOUS	P.T.	PREFABRICATED
CJ	CONTROL JOINT	R	PREMANUFACTURED
CORRUG.	CORRUGATED	RB	PRESSURE TREATED
CPT	CARPET	REF.	RADIUS
CT.	CERAMIC TILE	REFR.	RUBBER BASE
C.F.	CUBIC FEET	REINFC.	REFERENCE
CJ	CONTROL JOINT	REOD.	REINFORCED
CUST.	CUSTODIAL	RESIST	REQUIRED
DEG.	DEGREE	RET.	RETAINING
DENS.	DENSITY	RETRACT.	RETRACTABLE
DISP.	DISPENSER	REV.	REVISION
D.F.	DRINKING FOUNTIAN	R.O.	ROUGH OPENING
DIA.	DIAMETER	SALV.	SALVAGE
DIV.	DIVISION	SCHED.	SCHEDULE
DBL.	DOUBLE	S.C.	SEALED CONCRETE
EA	EACH	S.D.	SOAP DISPENSER
ELEC.	ELECTRICAL	SERV.	SERVICE
ELEV.	ELEVATION	SHEATHG.	SHEATHING
EQ.	EQUAL OR EQUIVALENT	SHT.	SHEET
EXIST	EXISTING	SIM.	SIMILAR
EXP.	EXPANSION	SOFTWD.	SOFTWOOD
EXT.	EXTERIOR	SQ.	SOLID CORE
FD.	FLOOR DRAIN	SQ.	SQUARE
FIN.	FINISH	S.S.	STAINLESS STEEL
F.E.	SURFACE MOUNTED	STD.	STANDARD
F.E.C.	FIRE EXTINGUISHER	STOR.	STORAGE
	FIRE EXTINGUISHER	STRUCT.	STRUCTURAL
	AND CABINET	SURFS.	STRUCTURAL SURFACES
F.F.	FINISHED FLOOR	SUSP.	SUSPENDED
FLR.	FLOOR	SV.	SHEET VINYL
F.T.	FIRE TREATED	SYNTH.	SYNTHETIC
FTG.	FOOTING	SYST.	SYSTEM
F.V.	FIELD VERIFY	T.V.	TELEVISION
FWD.	FORWARD	TEMPRD.	TEMPERED
FRAMG.	FRAMING	TEMP.	TEMPORARY
FURRG.	FURRING	THICK	THICKENED
GALV.	GALVANIZED	THRESH.	THRESHOLD
GA.	GAUGE	T&G	TONGUE & GROOVE
GB.	GRAB BAR	T.O.	TOP OF
GR.	GYP.	T.O.E	TOP OF EXISTING
GYP.	GYP.	T.G.	TOP OF GRADE
HDBD.	HARDBOARD	T.O.D.	TOP OF ROOF DECK
HDWD.	HARDWOOD	T&B	TOP AND BOTTOM
H.	HIGH	TRANS.	TRANSITION
HD.	HAND DRYER	T.W.C.	TACKABLE WALL COVERING
HT.	HEIGHT	TYP.	TYPICAL
HORIZ.	HORIZONTAL	UBC	UNIFORM BUILDING CODE
H.C.W.	HOLLOW CORE	UN.O.	UNLESS NOTED OTHERWISE
H.M.	HOLLOW METAL	VAN.	VANITY
HORIZ.	HORIZONTAL	V.B.	VENTED BASE
HR.	HOOR	VCT.	VINYL COMPOSITION TILE
IBC	INTERNATIONAL BUILDING CODE	VERT.	VERTICAL
INFILTR.	INFILTRATION	V.V.C.	VINYL WALL COVERING
INSUL.	INSULATION	WAINS.	WAINSCOT
IRRIG.	IRRIGATION	W.	WIDE
JT.	JOINT	W.C.	WATER CLOSET
L.	LONG	W/	WITH
LAM.	LAMINATED	W/O	WITH OUT
LAMIN.	LAMINATE	WD.	WOOD
LAT.	LATERAL		
LT.	LIGHT		
MANUF.	MANUFACTURER		
MAX	MAXIMUM		

## MATERIAL KEY

	EARTH
	CMU
	CONCRETE
	SAND
	STEEL CONT.
	WOOD BLKNNG
	CONT. WOOD
	PLYWOOD
	RIGID INSUL.
	CRUSHED GRAVEL

## SYMBOLS

BUILDING SECTION	
WALL SECTION	
DETAIL	
ELEVATION MARK	
REVISIONS	
WINDOW TYPES	
FLOOR & WALL ASSEMBLIES	
ROOF ASSEMBLIES	
DOOR NUMBERS	
EXTERIOR ELEVATION	A1/A5.01
INTERIOR ELEVATION	A1/A5.10

## VICINITY MAP

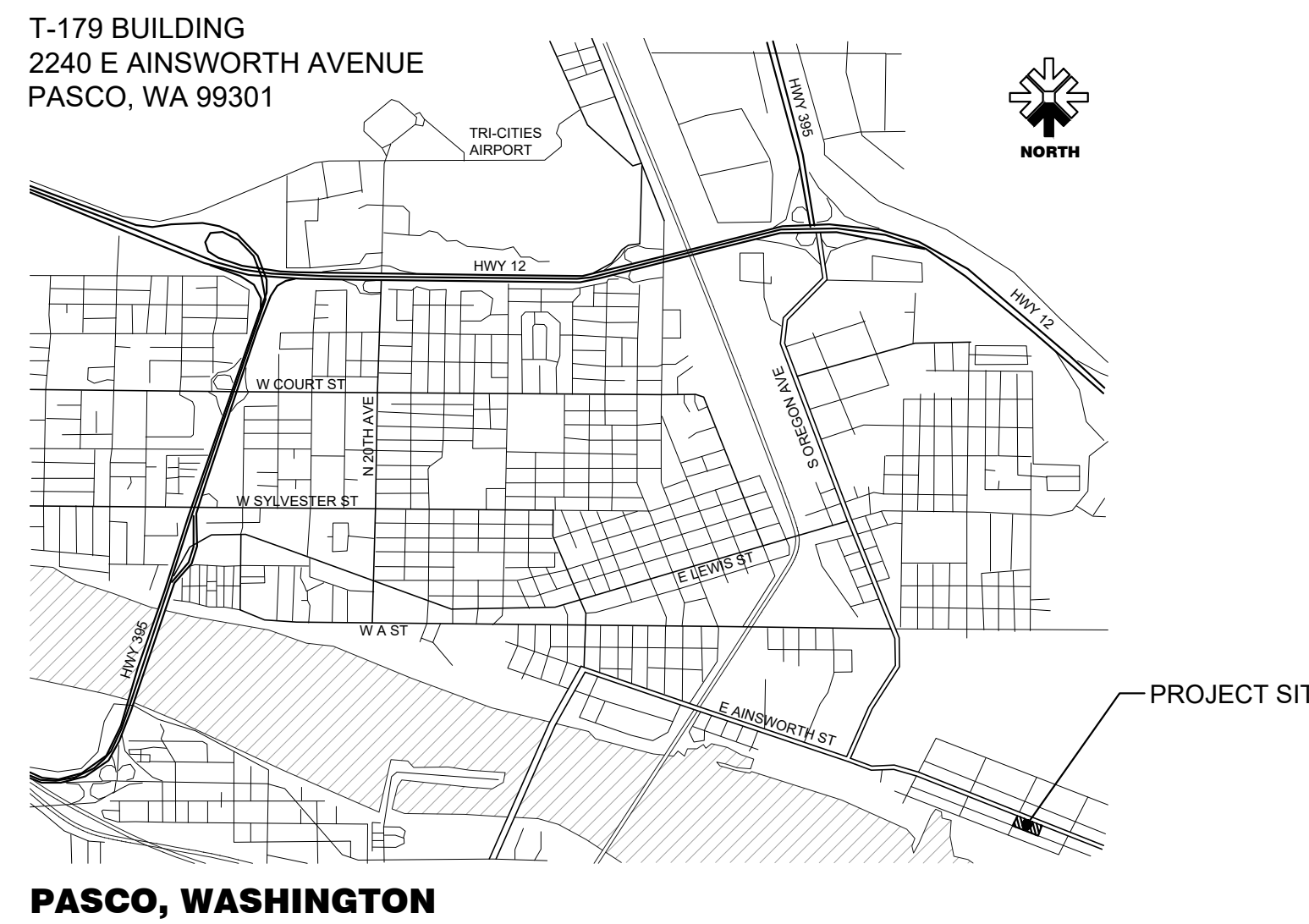

## KEY PLAN (BIG PASCO INDUSTRIAL CENTER)

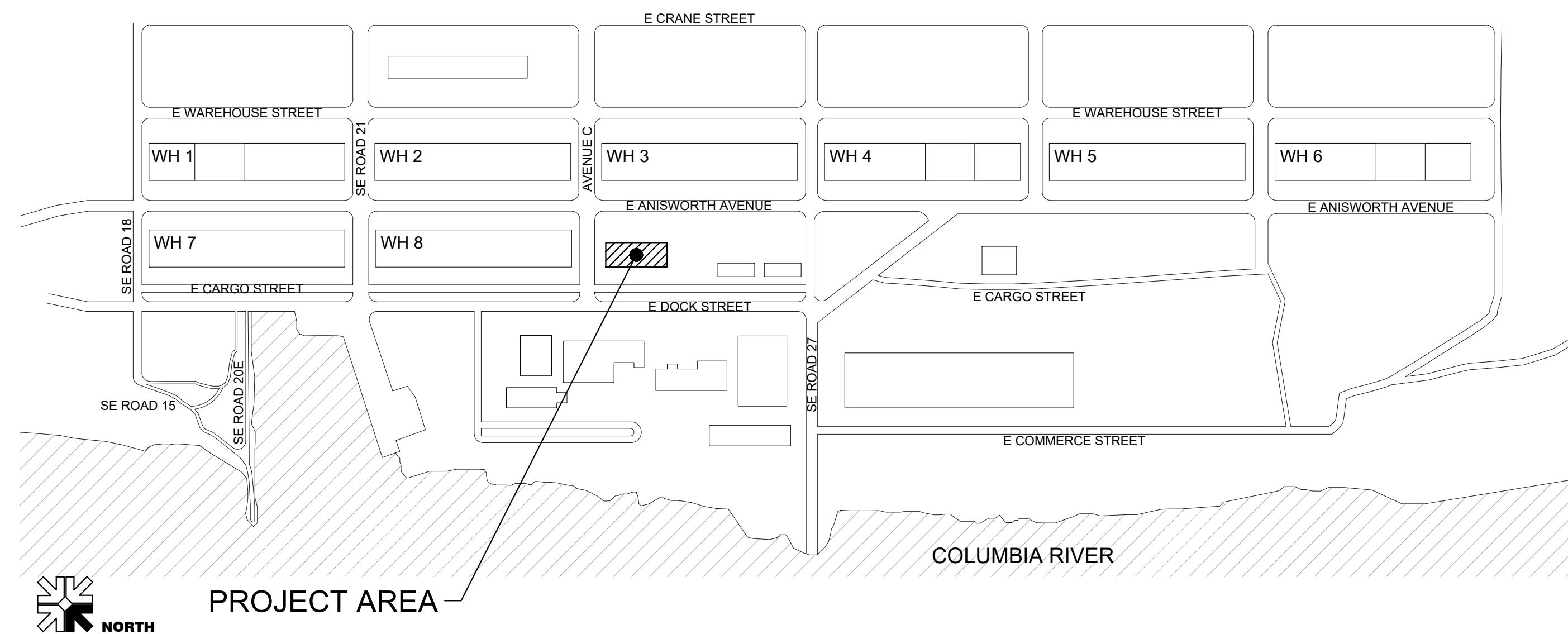

## DRAWING INDEX

ARCHITECTURAL:	
A1.00	TITLE SHEET
A2.01	ROOF DEMOLITION PLAN
A3.60	ROOF PLAN
A3.61	DETAILS

## PROJECT TEAM

<b>OWNER</b>		<b>CONTACT:</b>
PORT OF PASCO		JAMIE VERA
1110 OSPREY POINTE BLVD, SUITE 201		
P.O. BOX 769		
PASCO, WASHINGTON 99301		
TEL: (509) 543-6700		
EMAIL: JVERA@PORTOFPASCO.ORG		
<b>ARCHITECTURAL</b>		<b>CONTACT:</b>
DESIGN WEST ARCHITECTS P.A.		MATT WHITISH
830 N COLUMBIA CENTER BLVD.		
KENNEWICK, WASHINGTON 99336		
TEL: (509) 783-2244		



DRAWN BY	AR
CHECKED BY	MaW
JOB NUMBER	26025
REVISIONS	

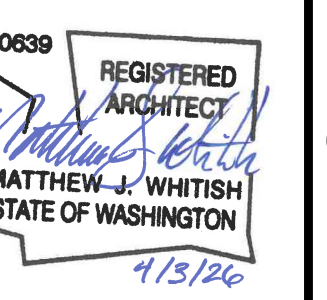

**PORT OF PASCO**  
**T-179 BUILDING RE-ROOF**  
**2440 E AINSWORTH AVENUE**  
**PASCO, WASHINGTON 99301**

DATE  
**04/03/2026**

SHEET NAME

**TITLE SHEET**

SHEET  
**A1.00**

**SHEET NOTES**

- SEE SHEET A1.00 FOR SYMBOLS & ABBREVIATIONS.
- REMOVE ALL EXISTING ROOFTOP EQUIPMENT, CURBS AND ACCESSORIES, AND PROVIDE INFILLS AS DETAILED. REPLACE DAMAGED SURFACES DUE TO DEMOLITION REMOVAL OR CONSTRUCTION OPERATIONS, TYP.
- CONTRACTOR IS RESPONSIBLE FOR ANY DAMAGE TO ADJACENT WORK AND IS RESPONSIBLE FOR THE REPAIR OF ANY DAMAGE AT CONTRACTOR'S OWN EXPENSE.
- NOT ALL DEMOLITION IS SHOWN ON SHEET A2.01. CONTRACTOR SHALL INCLUDE ALL DEMOLITION WORK REQUIRED TO ACCOMPLISH NEW WORK SHOWN IN ARCHITECTURAL ATTACHED DRAWING SHEETS. REVIEW COMPLETE SET OF NEW CONSTRUCTION DOCUMENTS PRIOR TO STARTING DEMOLITION.
- CONTRACTOR IS RESPONSIBLE FOR REVIEWING EXISTING ROOF CONDITIONS TO DETERMINE THE EXTENT OF WORK REQUIRED TO COMPLETE THE PROJECT.
- ALL UTILITY SERVICES SHALL REMAIN FUNCTIONAL TO THE EXISTING FACILITY FOR THE DURATION OF THE PROJECT. COORDINATE TEMPORARY SHUT-DOWNS WITH OWNER AND DESIGN TEAM. APPROVED TEMPORARY RE-ROUTING OF SERVICES AT CONTRACTOR'S OPTION.
- ALL EXISTING ROOF TOP CONDUITS, PLUMBING PIPING, ETC. TO BE RESET IN SAME LOCATION WITH NEW ROOF SYSTEM, PROVIDE ALL CONNECTIONS AND FLASHING TO PROVIDE WEATHER-TIGHT INSTALLATION.
- EXISTING TPO MEMBRANE AND ROOF THERMAL INSULATION TO REMAIN. NEW ROOFING MEMBRANE TO BE INSTALLED OVER EXISTING.

**DEMOLITION PLAN NOTES**

- D1 PRESERVE AND PROTECT EXISTING BUILDING, ELEMENTS AND/OR FINISHES TO REMAIN.
- D2 PRESERVE AND PROTECT ALL EXISTING MECHANICAL, ELECTRICAL, AND PLUMBING UNITS/ITEMS.
- D3 PRESERVE AND PROTECT EXISTING ROOF HATCH AND ANY COMPONENTS ASSOCIATED WITH THE ASSEMBLY. REMOVE AND RE-INSTALL IF NEEDED TO INSTALL NEW ROOFING MEMBRANE.
- D4 EXISTING ROOF MEMBRANE ASSEMBLY TO REMAIN. NEW ROOFING MEMBRANE TO BE INSTALLED OVER EXISTING. REMOVE ALL DEBRIS, WALL TERMINATIONS, FASTENERS, FLASHING, AND ANY OTHER ELEMENTS AS REQUIRED FOR INSTALLATION OF NEW ROOFING SYSTEM.
- D5 REMOVE EXISTING METAL GUTTER, DOWNSPOUTS, AND SCUPPER ASSEMBLIES. PATCH BACK, REPAIR, AND PREPARE TO RECEIVE NEW CONTINUOUS METAL GUTTER.
- D6 REMOVE EXISTING METAL EDGE FLASHING AND ASSOCIATED COMPONENTS AS REQUIRED TO INSTALL NEW ROOF EDGE FLASHING.

- D7 PRESERVE AND PROTECT EXISTING ROOF VENT PIPE. REMOVE EXISTING CAPS AT ALL ROOF VENTS AND PREPARE VENTS TO RECEIVE NEW CAPS.
- D8 REMOVE EXISTING METAL PANEL CAP AT PREVIOUSLY REMOVED SKYLIGHT. PREPARE OPENING FOR NEW IN FILL CONSTRUCTION.
- D9 REMOVE EXISTING 4'X8' SKYLIGHT UNIT AND ASSOCIATED FLASHINGS AND CURBS.
- D10 REMOVE EXISTING ABANDONED 4-FT Ø VENT PIPE.
- D11 REMOVE EXISTING TPO MEMBRANE AND PREPARE SUBSTRATE TO RECEIVE NEW ROOFING.

**DEMOLITION LEGEND**

- EXISTING
- DEMO
- EXISTING ROOF MEMBRANE SYSTEM TO REMAIN
- DEMO EXISTING ROOF MEMBRANE SYSTEM
- DEMOLITION KEY NOTE



DRAWN BY  
AR

CHECKED BY  
MaW

JOB NUMBER  
26025

REVISIONS

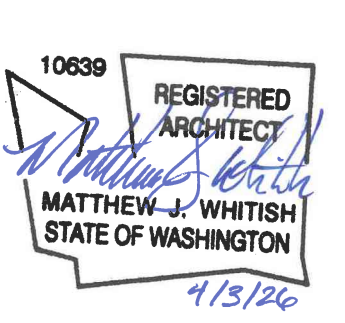

**PORT OF PASCO  
T-179 BUILDING RE-ROOF**

2440 E AINSWORTH AVENUE  
PASCO, WASHINGTON 99301

DATE  
**04/03/2026**

SHEET NAME  
**ROOF DEMOLITION PLAN**

SHEET  
**A2.01**

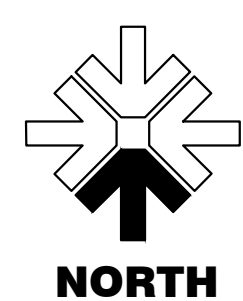
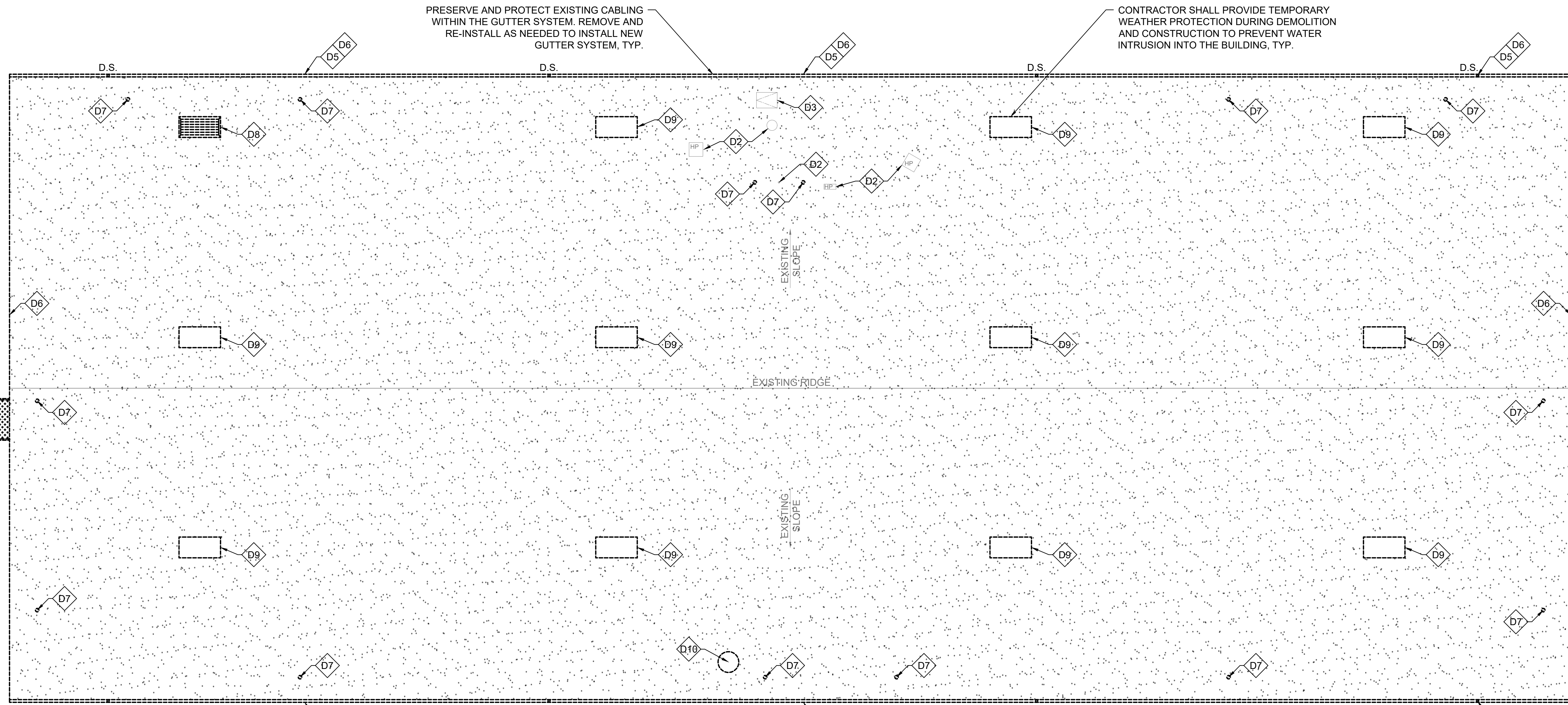

**A1 ROOF DEMOLITION PLAN**

SCALE: 3/32" = 1'-0"

NOTE DRAWING SCALE

**SHEET NOTES**

- SEE SHEET A1.00 FOR SYMBOLS & ABBREVIATIONS.
- SEE SPECIFICATION 07 54 00 FOR TPO ROOFING SYSTEM DESCRIPTION.
- PROVIDE ALL NECESSARY ROOFING ACCESSORIES INCLUDING: REGLETS, BINDER BARS, FLASHING, COLLARS & BOOTS, FASTENERS, ETC. FOR A COMPLETE WARRANTIES ROOF SYSTEM INSTALLATION.
- PRIOR TO ROOFING INSTALLATION, CONTRACTOR SHALL PHYSICALLY INSPECT ROOF SLOPE TO VERIFY ADEQUATE DRAINAGE.
- THE CONSTRUCTION DRAWINGS DO NOT DETAIL ALL TPO CONDITIONS. VERIFICATION OF ALL EXISTING FIELD CONDITIONS NECESSARY TO PROVIDE A COMPLETE, FINISHED, SEALED, AND FULLY WARRANTED RE-ROOF INSTALLATION IS THE RESPONSIBILITY OF THE CONTRACTOR.
- CONTRACTOR TO PROVIDE NEW SEALANT AT ALL CONNECTORS, JOINTS, AND METAL COPING CONDITIONS, AND PROVIDE ALL FASTENERS WITH OVERSIZED NEOPRENE WASHERS.
- CONTRACTOR IS RESPONSIBLE FOR COORDINATING WITH BOTH THE OWNER AND ARCHITECT TO ADDRESS ANY ADDITIONAL REQUIREMENT NECESSARY FOR THE TEMPORARY REMOVAL OF ROOF EQUIPMENT.
- ALL EXPOSED METAL AND FLASHING TO BE PRE-FINISHED SHEET METAL FLASHING AND TRIM (07 62 00). MATCH ADJACENT MATERIAL COLOR BEING FLASHED.
- THE ARCHITECTURAL DRAWINGS PROVIDE A REFERENCE FOR THE GENERAL LOCATION OF MECHANICAL, PLUMBING, AND ELECTRICAL UNITS/ITEMS, AS WELL AS THE EXISTING ROOF SLOPES, DRAINS, CRICKET LOCATIONS...ECT. THE CONTRACTOR IS RESPONSIBLE TO FIELD VERIFY THE CURRENT ROOF LAYOUT TO DETERMINE THE QUANTITY OF UNITS/ITEMS NOT BEING SHOWN ON THE DRAWINGS.
- CONTRACTOR SHALL SEQUENCE AND STAGE THE WORK TO ALLOW FOR OCCUPANCY OF THE BUILDING AND SURROUNDING PARKING AND LANDSCAPE AREAS.

**ROOF LEGEND**

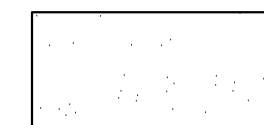
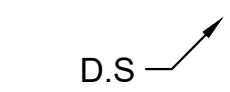
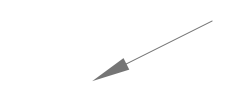
-  TPO ROOFING SYSTEM (NEW)
-  D.S. DOWNSPOUT (NEW)
-  EXISTING DRAINAGE DIRECTION

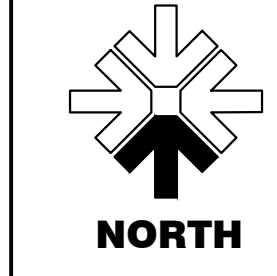

**E8 ROOF PLAN**

SCALE: 1/2" = 1'-0"

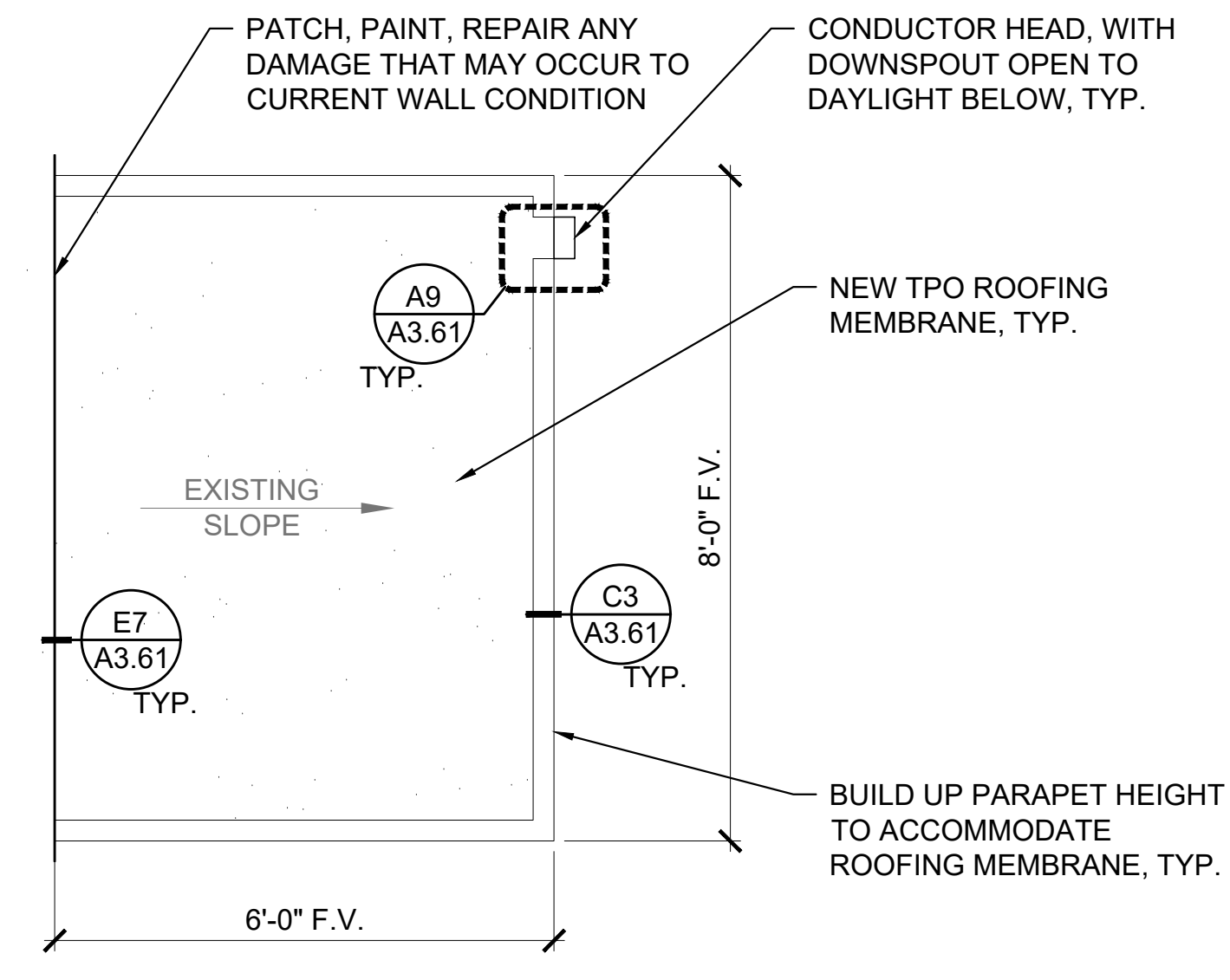

**DESIGN WEST ARCHITECTS P.A.**  
 • MERIDIAN, IDAHO • PULLMAN, WASHINGTON •  
 • KENNEWICK, WASHINGTON • OREGON

www.designwestpa.com

© COPYRIGHT 2026 DESIGN WEST ARCHITECTS, INC. ALL RIGHTS RESERVED. THIS DRAWING MUST BE REPRODUCED WITHOUT THE PERMISSION OF ARCHITECT.

DRAWN BY	AR
CHECKED BY	MaW
JOB NUMBER	26025
REVISIONS	

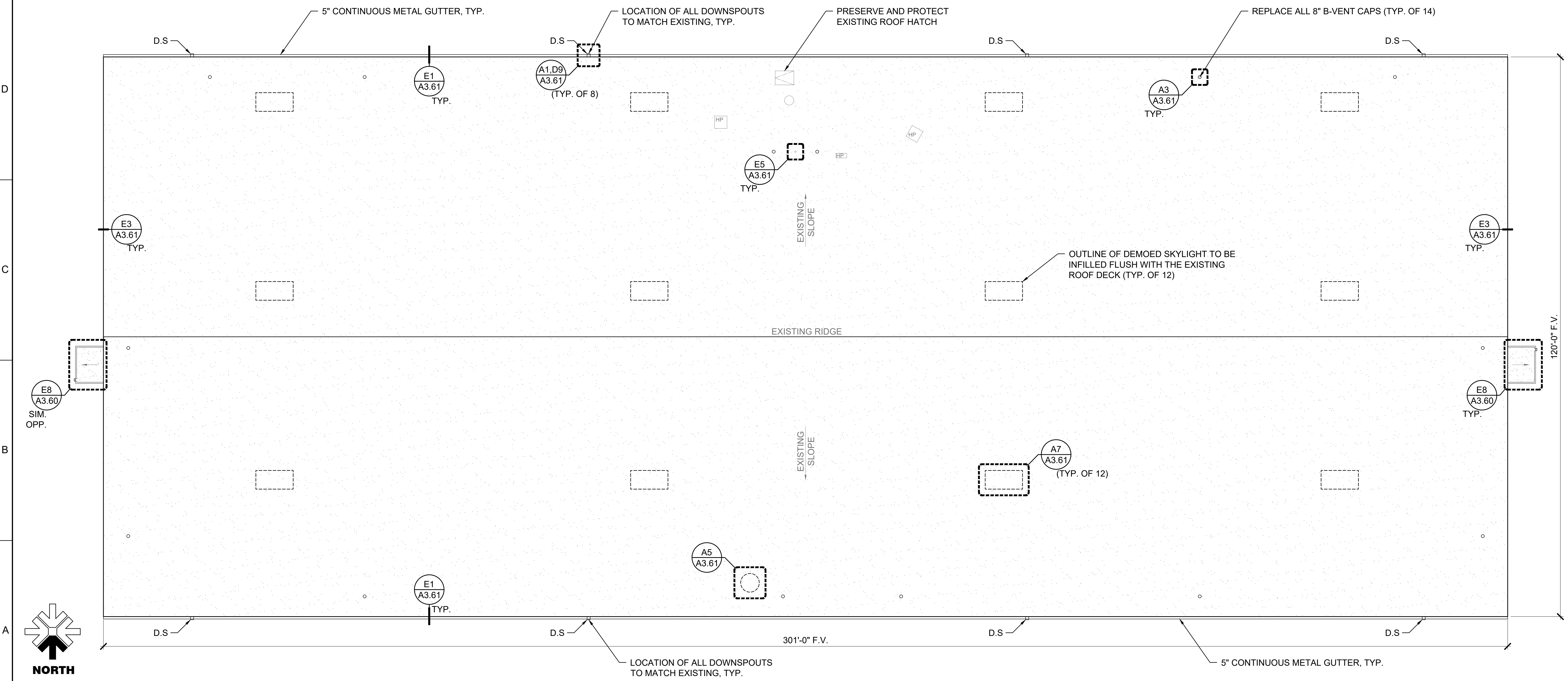

**A1 ROOF PLAN**

SCALE: 3/32" = 1'-0"

NOTE DRAWING SCALE

10639 REGISTERED ARCHITECT  
 Matthew J. Whitish  
 MATTHEW J. WHITISH  
 STATE OF WASHINGTON  
 1/3/26

**PORT OF PASCO  
 T-179 BUILDING RE-ROOF**  
 2440 E AINSWORTH AVENUE  
 PASCO, WASHINGTON 99301

DATE  
**04/03/2026**

SHEET NAME

**ROOF PLAN**

SHEET  
**A3.60**

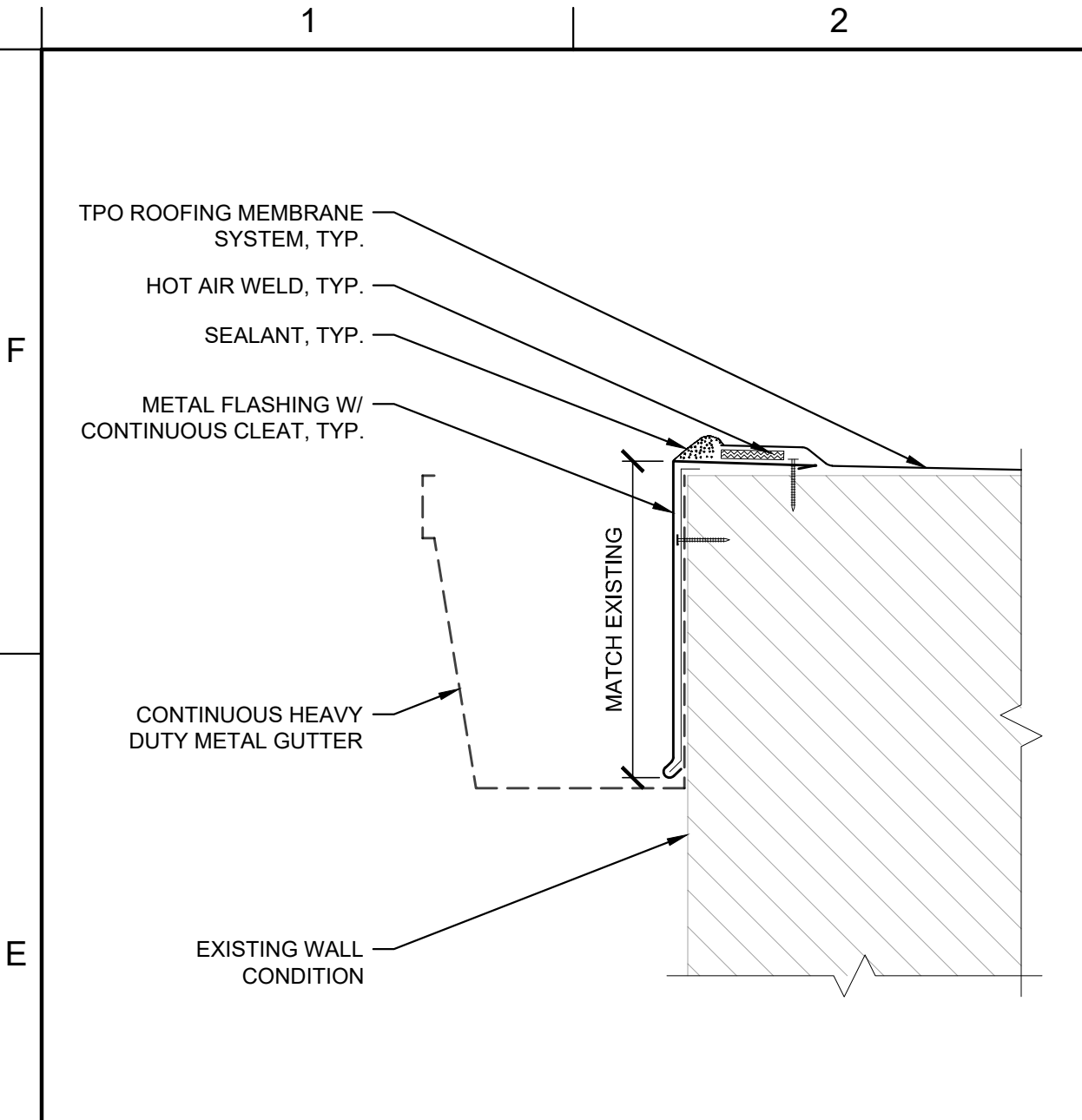

**E1 ROOF EAVE EDGE**  
SCALE: 3" = 1'-0"  
ROOF EDGE

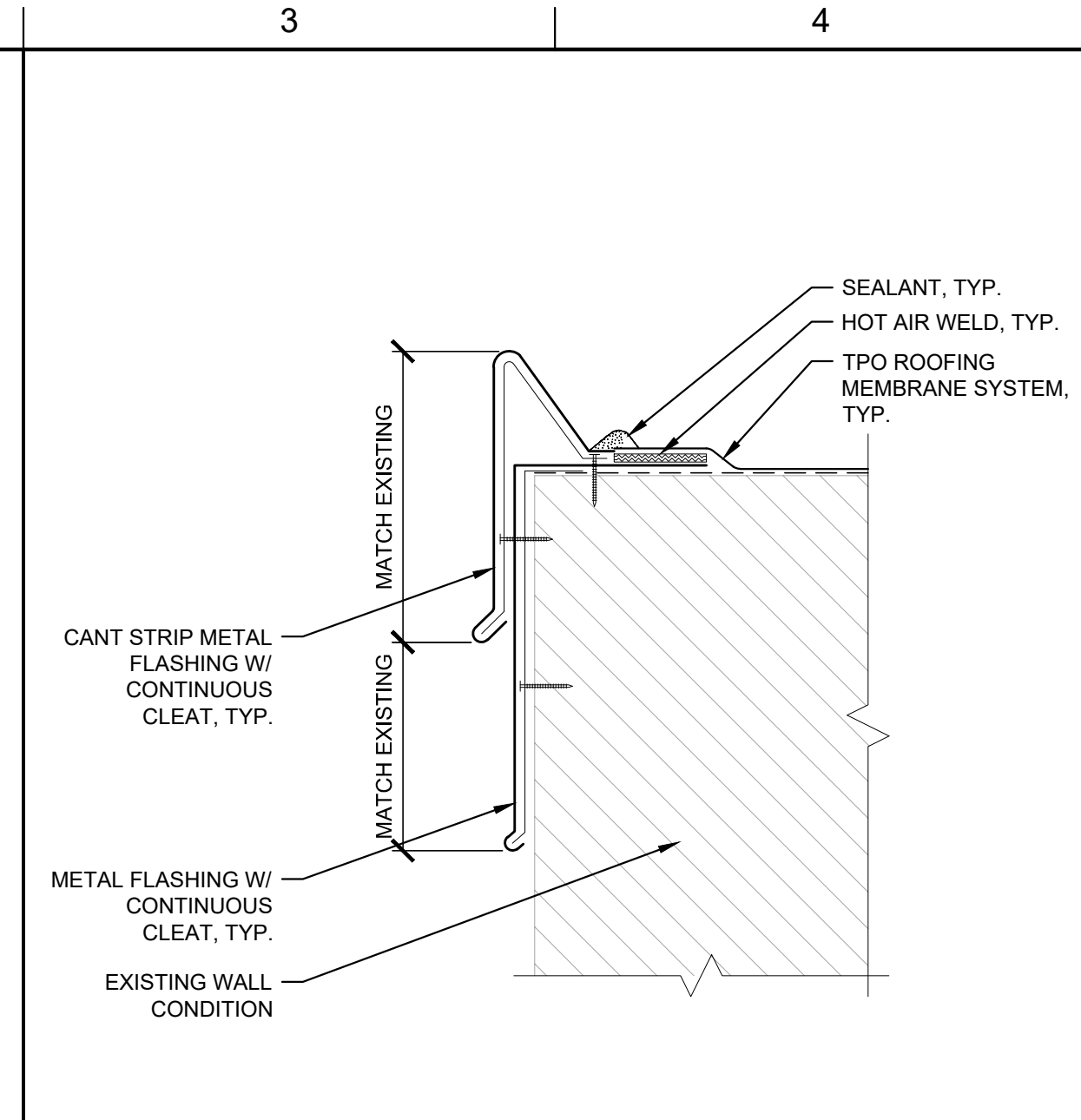

**E3 ROOF RAKE EDGE**  
SCALE: 3" = 1'-0"  
ROOF RAKE EDGE

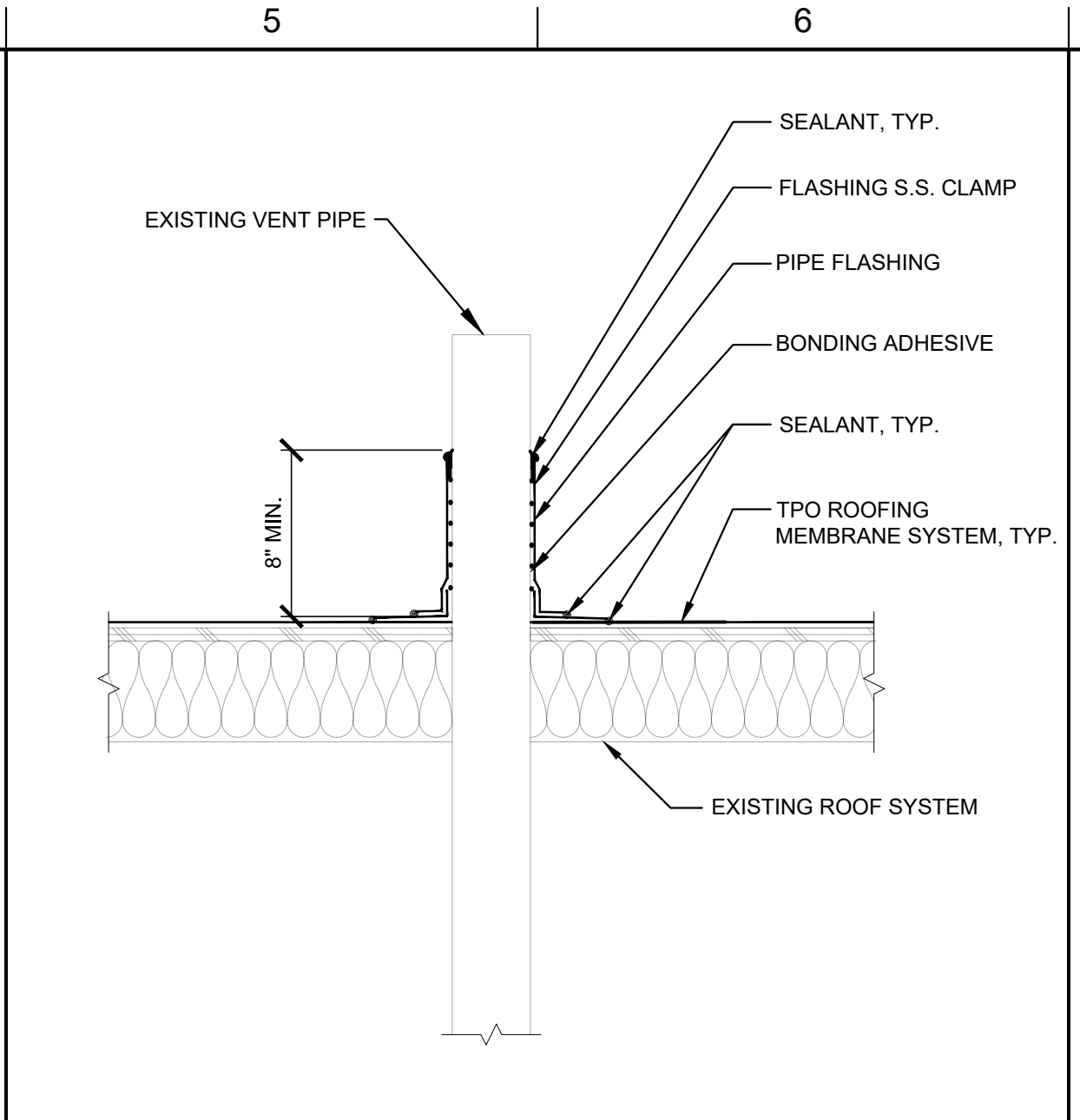

**E5 VENT PIPE PENETRATION**  
SCALE: 1 1/2" = 1'-0"  
VENT PENETRATION

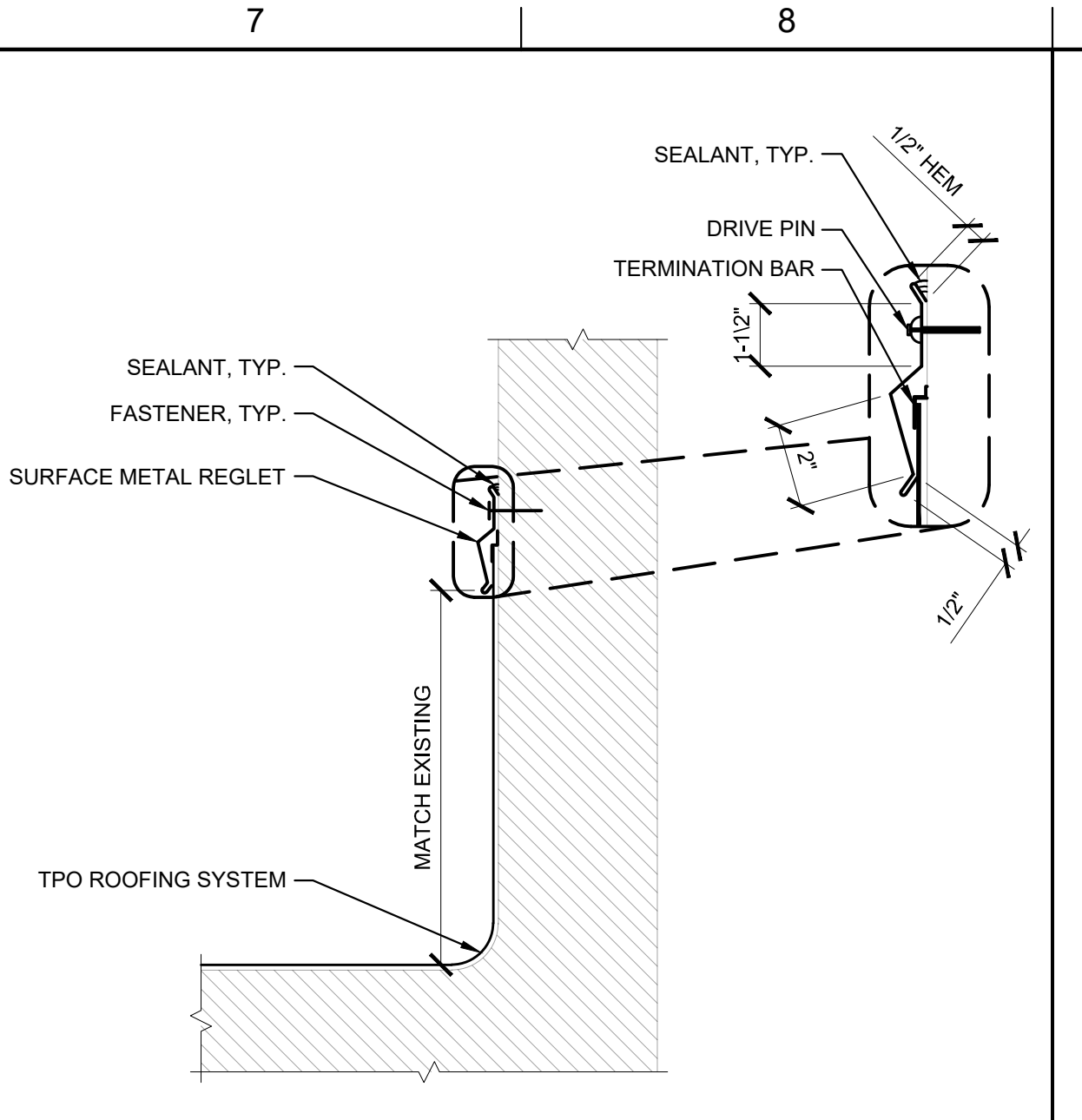

**E7 SURFACE MOUNT REGLET FLASHING**  
SCALE: 1 1/2" = 1'-0"  
REGLET DETAIL

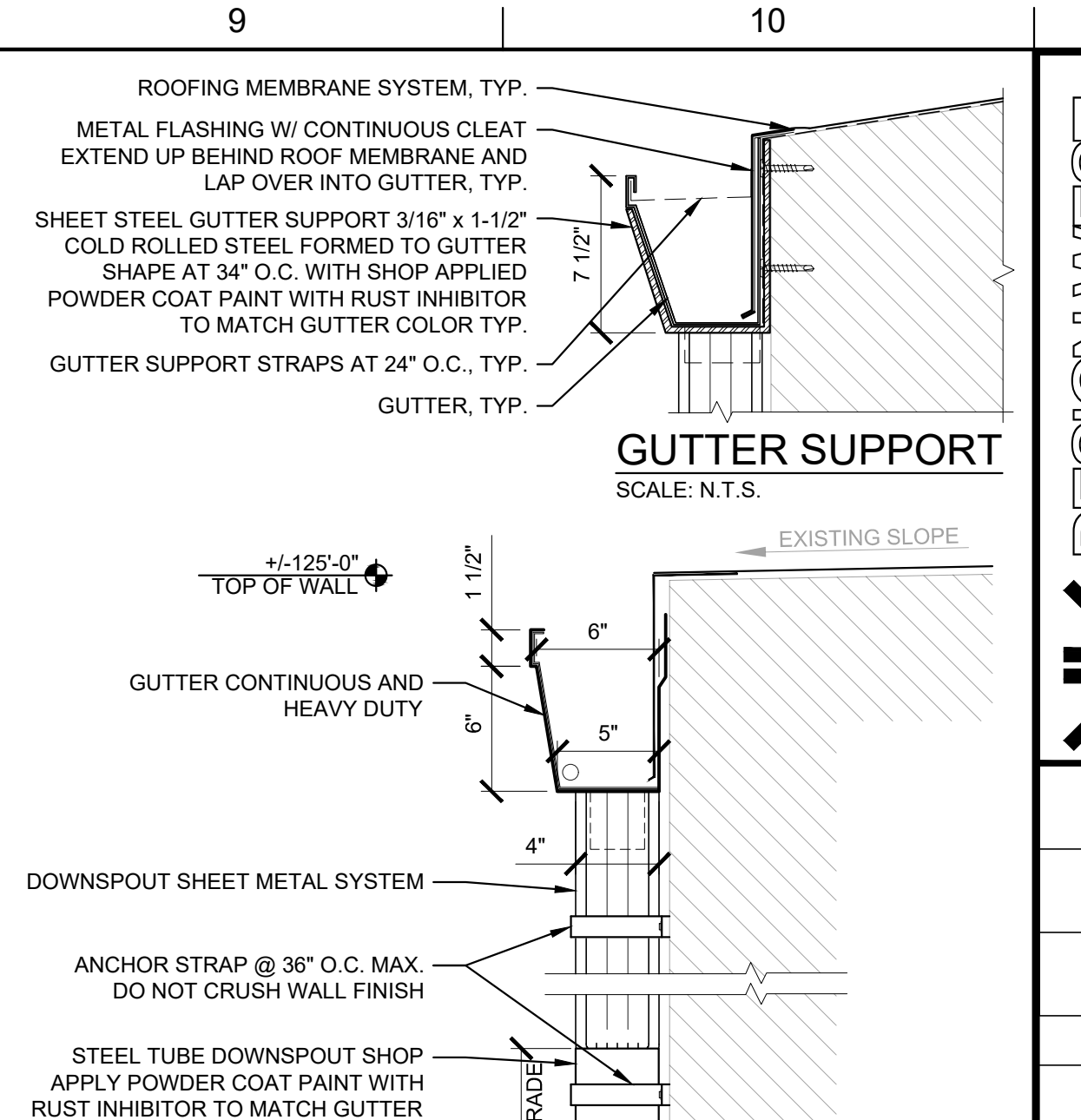

**GUTTER SUPPORT**  
SCALE: N.T.S.

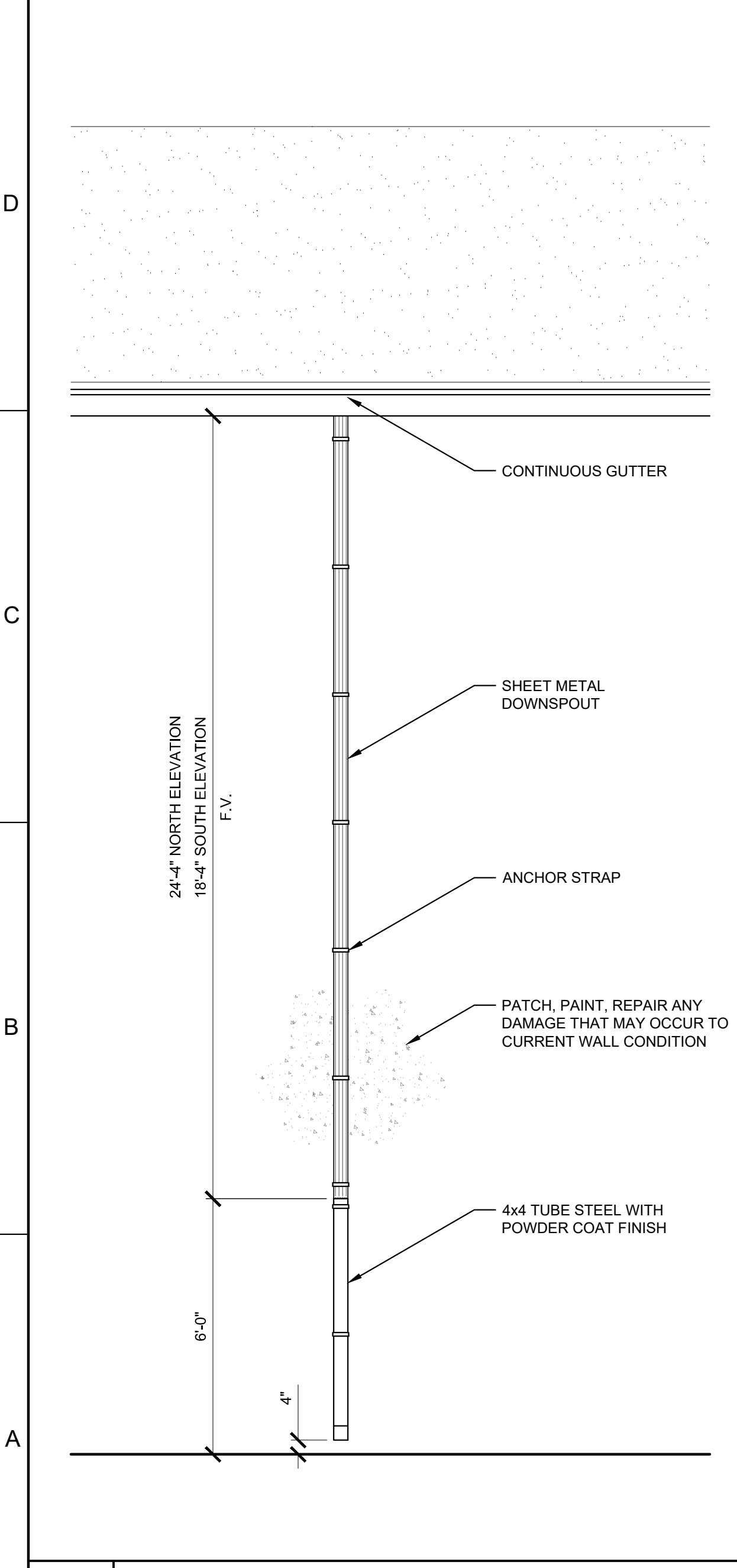

**A1 DOWNSPOUT ELEVATION**  
SCALE: 3/8" = 1'-0"  
DOWNSPOUT ELEVATION

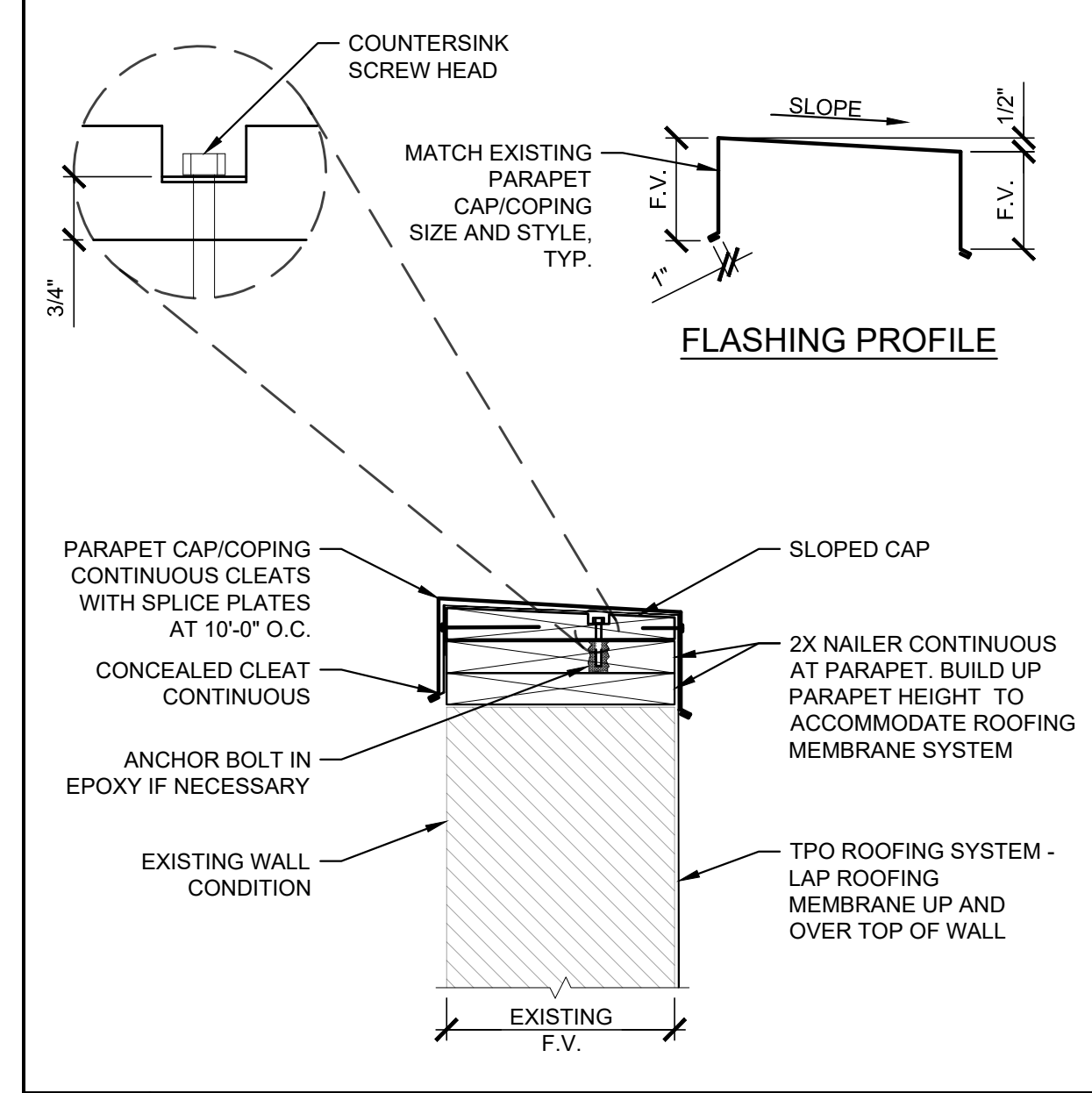

**C3 NEW PARAPET CAP AT EXIST WALL**  
SCALE: 1 1/2" = 1'-0"  
PARAPET CAP

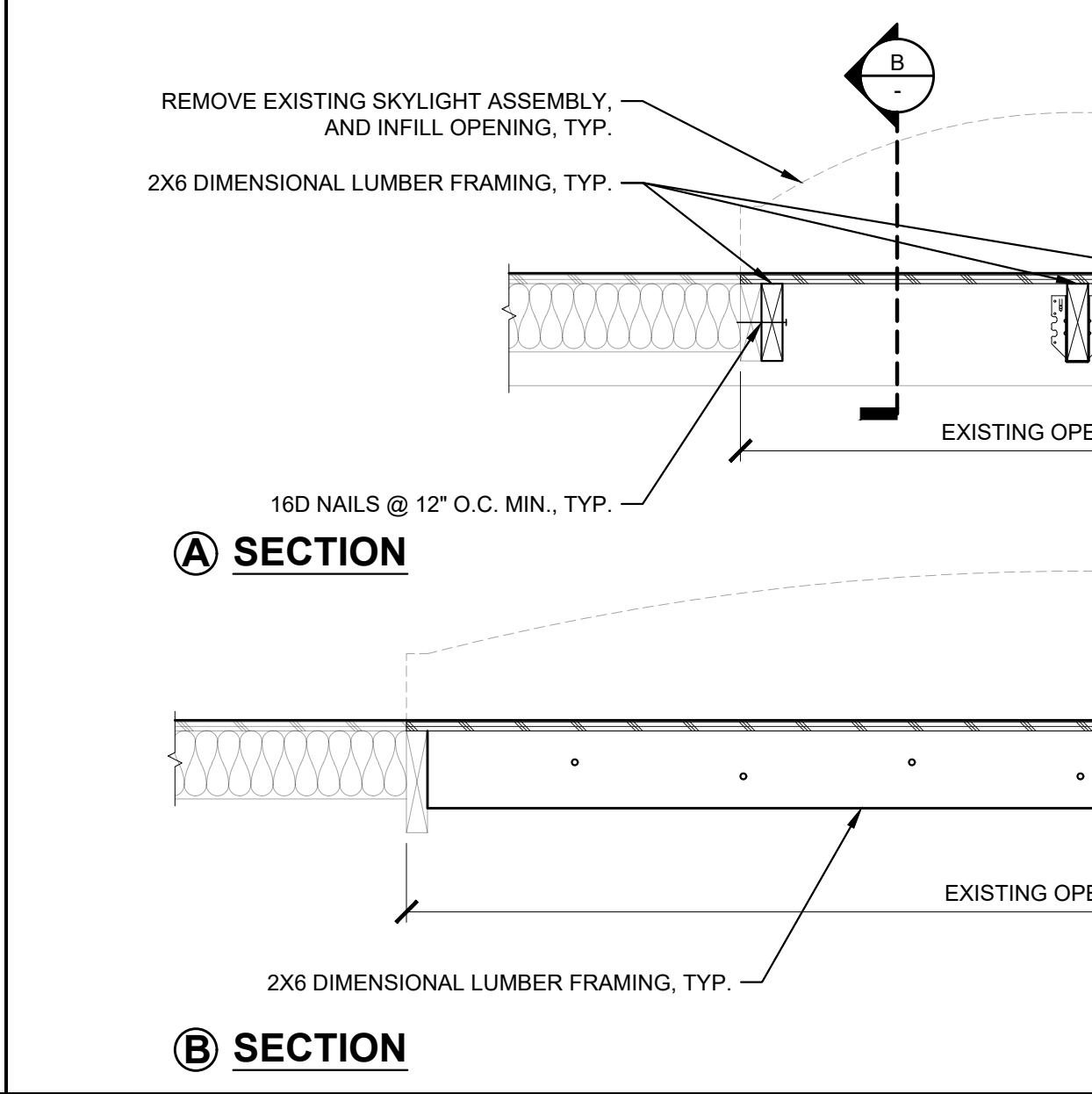

**C5 INFILL ROOF OPENING**  
SCALE: 1" = 1'-0"  
ROOF OPENING

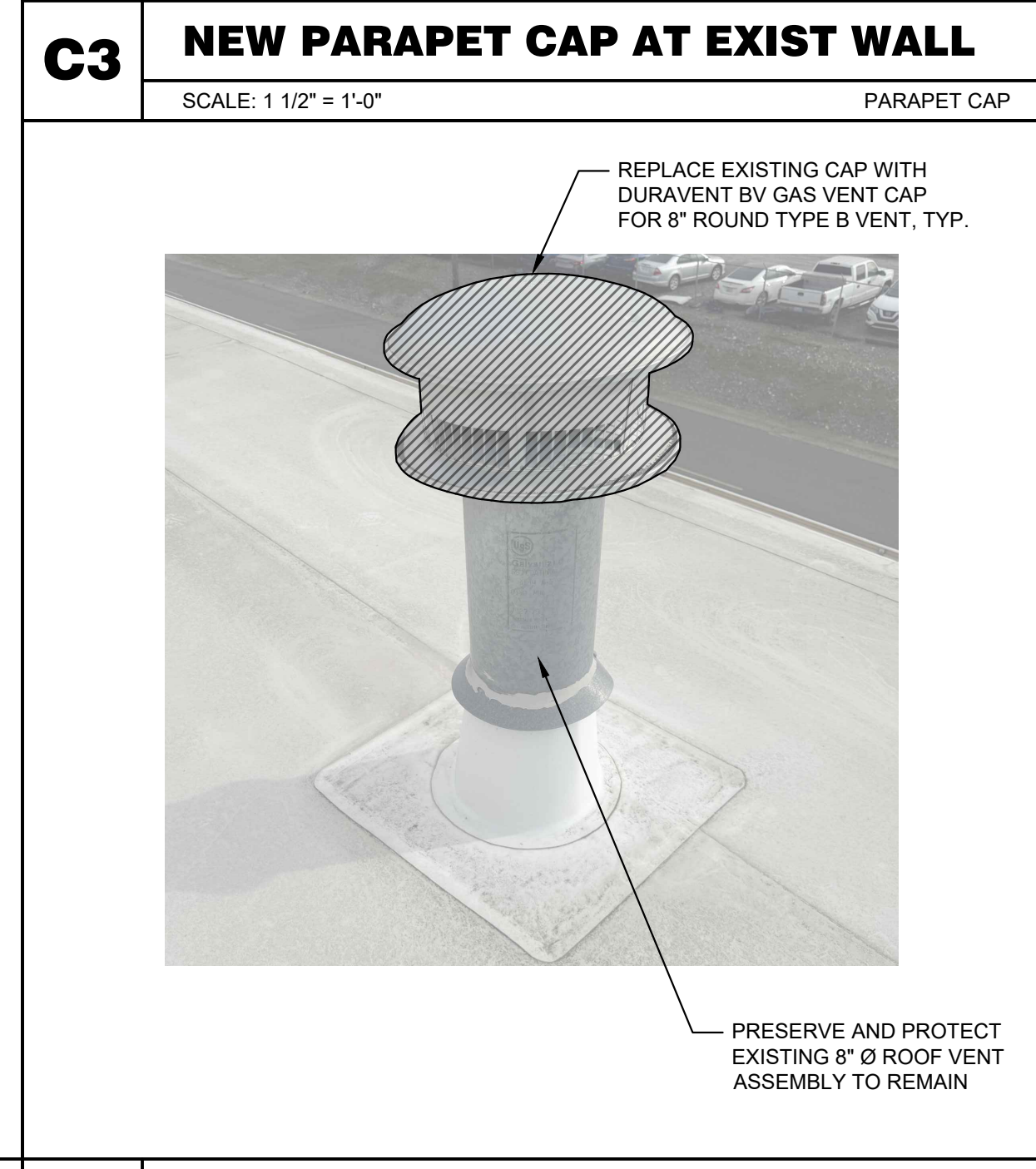

**A3 EXISTING VENT PIPE**  
SCALE: 1 1/2" = 1'-0"  
EXISTING VENT PIPE

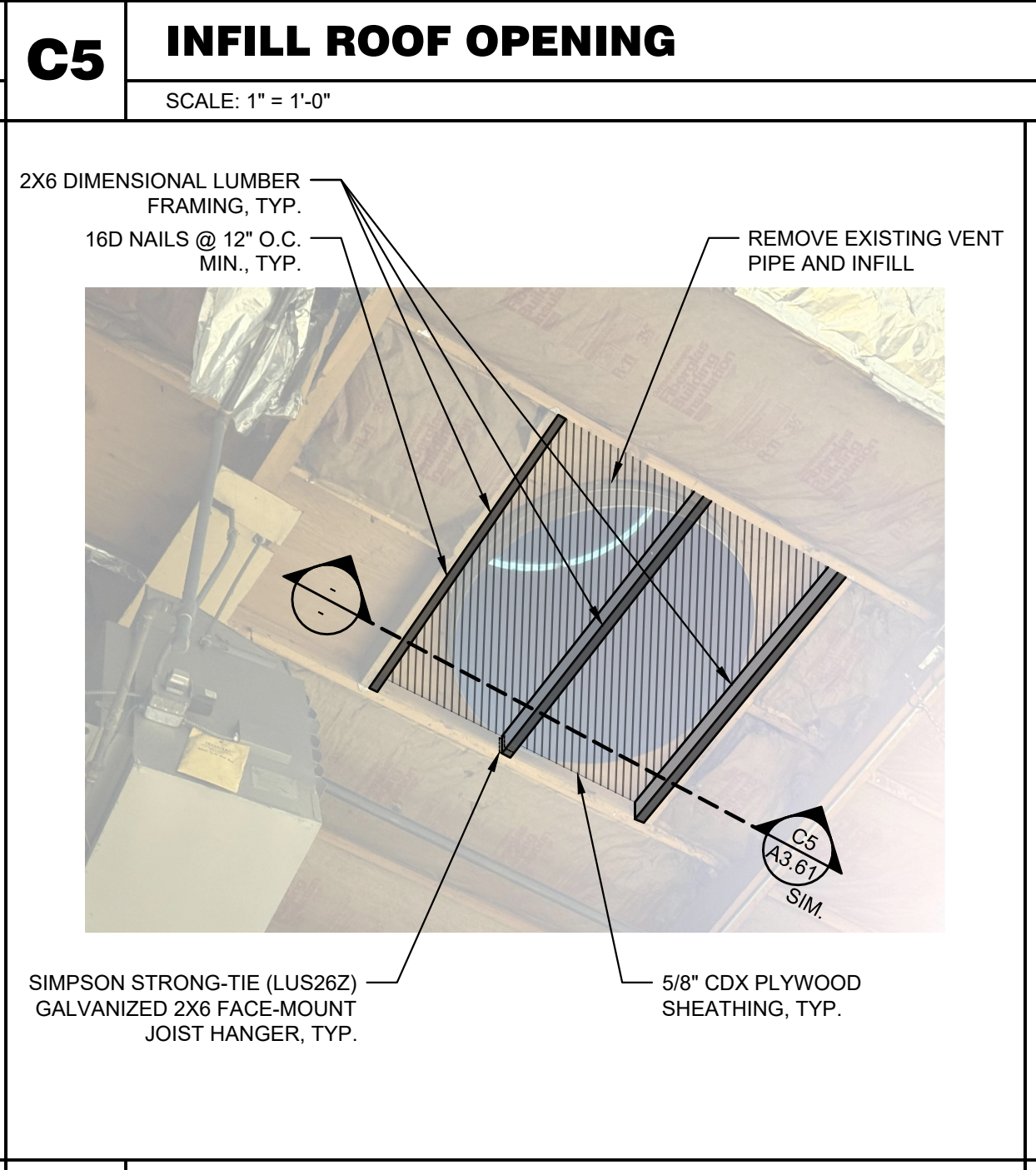

**A5 EXISTING VENT PIPE INFILL**  
SCALE: 1 1/2" = 1'-0"  
VENT PIPE INFILL

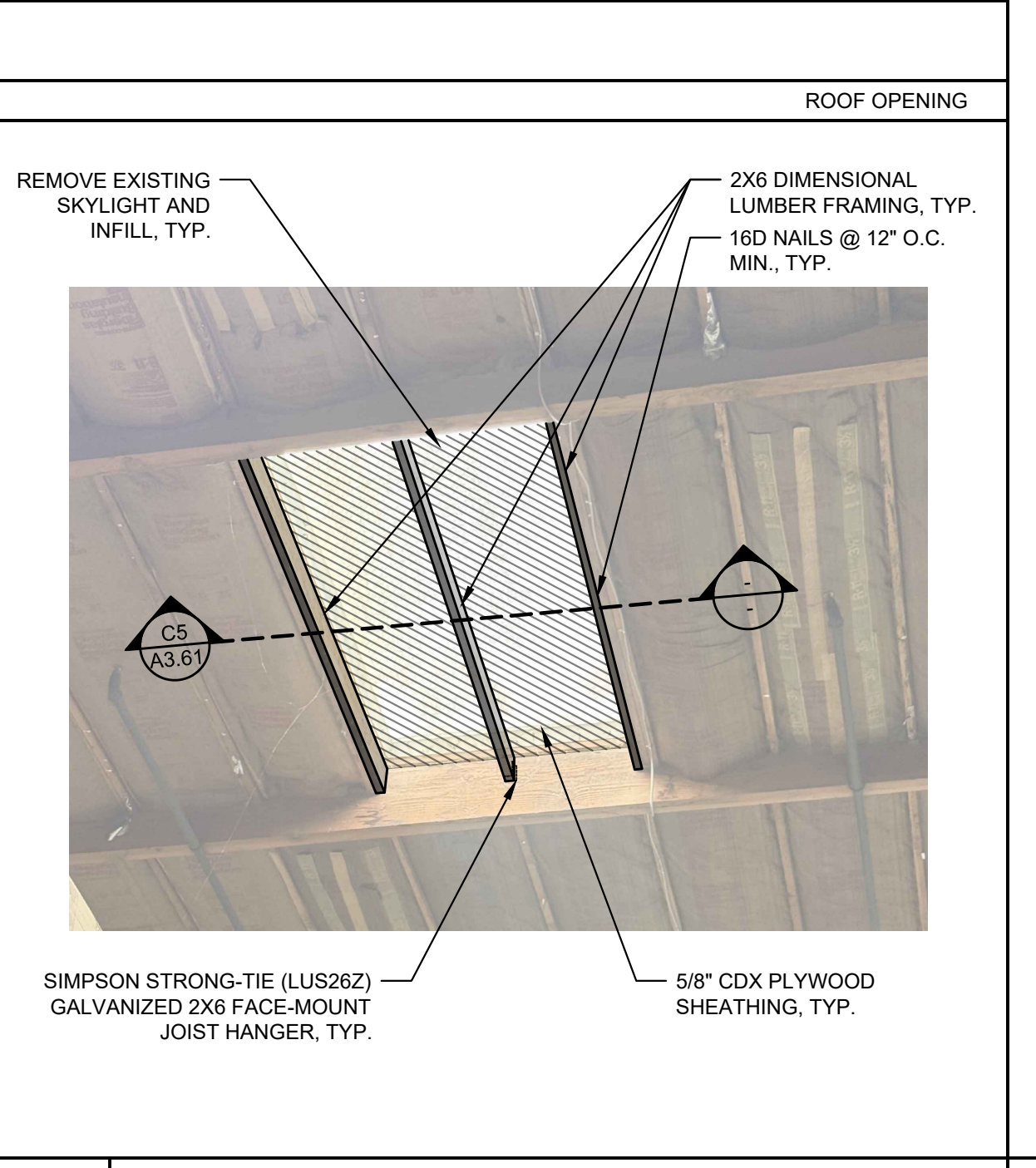

**A7 EXISTING SKYLIGHT INFILL**  
SCALE: 1 1/2" = 1'-0"  
SKYLIGHT INFILL

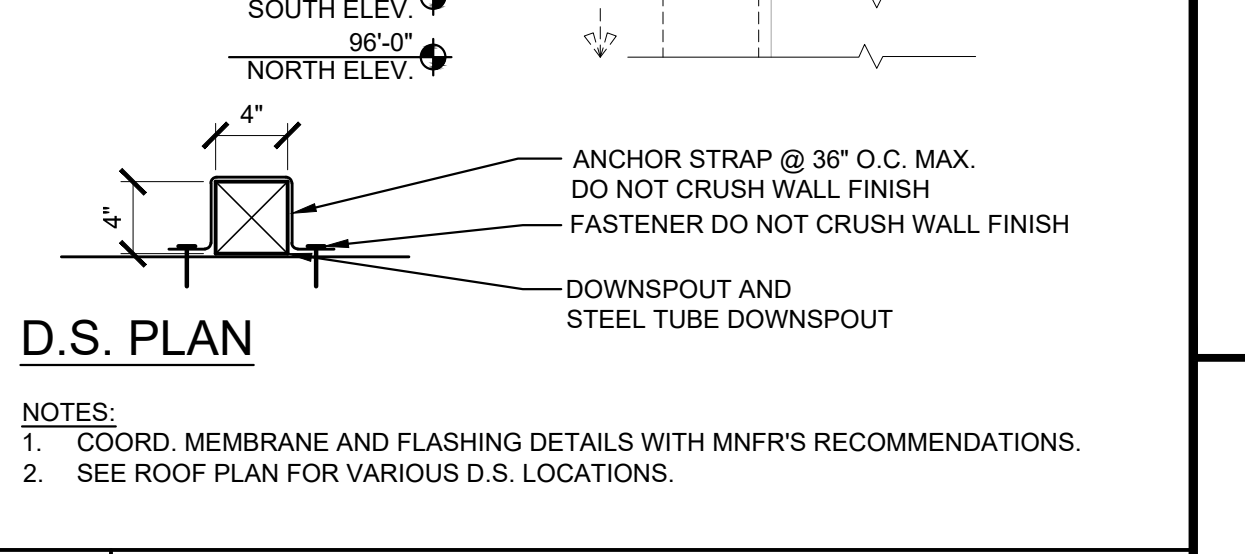

**D9 DOWNSPOUT AND GUTTER**  
SCALE: 1 1/2" = 1'-0"  
DOWNSPOUT 02

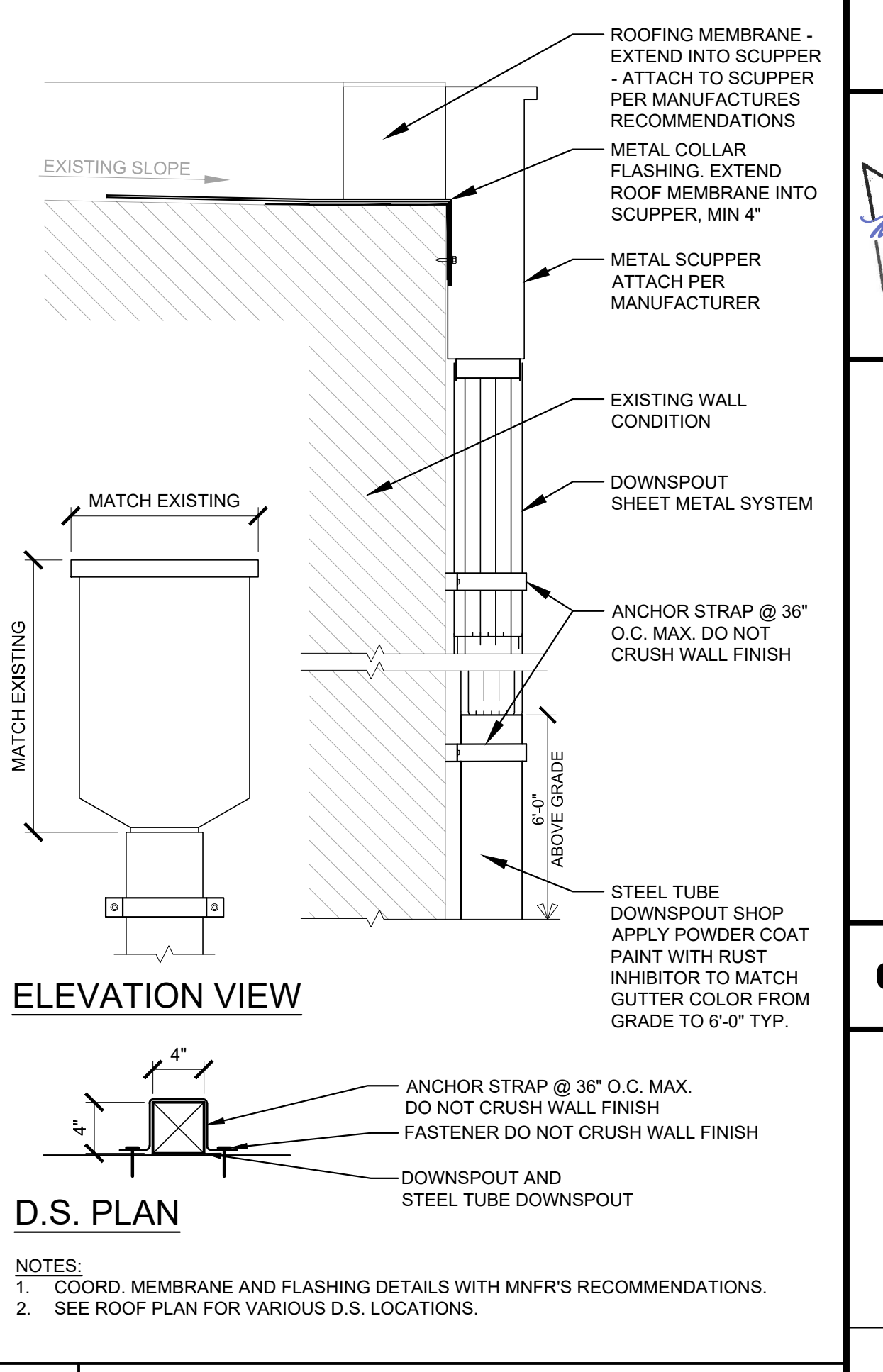

**A9 SCUPPER DOWNSPOUT**  
SCALE: 1 1/2" = 1'-0"  
DOWNSPOUT 01

**DESIGN WEST ARCHITECTS P.A.**  
MERIDIAN, IDAHO • PULLMAN, WASHINGTON • KENNEWICK, WASHINGTON • OREGON

DRAWN BY AR  
CHECKED BY MaW  
JOB NUMBER 26025  
REVISIONS

**PORT OF PASCO T-179 BUILDING RE-ROOF**  
2440 E AINSWORTH AVENUE  
PASCO, WASHINGTON 99301

DATE 04/03/2026  
SHEET NAME DETAILS  
SHEET A3.61